



RED WHITE Cast Iron Gate Valve – 125 lb Fig. No. 511

Features

- Outside Screw and Yoke
- Rising Stem
- Solid Wedge Disc
- Bronze Trimmed
- Flanged Ends
- Conforms to Specifications of MSS-SP-70

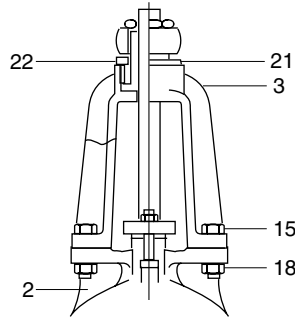
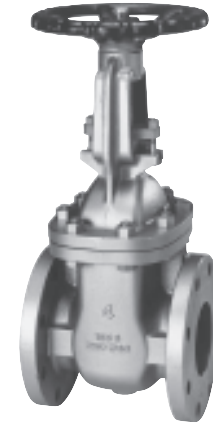

Fig. 1



Working Pressures

Working Pressure Non-Shock (psi)		Test Pressure (psi)	
Saturated Steam	Cold Water, Oil, Gas	Shell (Water)	Seat (Water)
125	200	350	220

Materials & Specifications

Item	Description	Material	Specification
1	Body	Cast iron	ASTM A126 Class B
2	Bonnet	Cast iron	ASTM A126 Class B
3	Yoke	Cast iron	ASTM A126 Class B
4	Disc	Cast iron	ASTM A126 Class B
5	Handwheel	Ductile iron	ASTM A536 Grade 60-40-18
6	Body seat ring	Stainless Steel	A182 Grade F6a
7	Disc seat ring	Stainless Steel	A182 Grade F6a
8	Stem	Stainless Steel	A182 Grade F6a
9	Gland	Stainless Steel	A182 Grade F6a
10	Yoke sleeve	Cast bronze	ASTM B62-C83600
11	Wheel nut	Steel	ASTM A36
12	Washer	Brass plate	ASTM B36-C2600
13	Bonnet bolt	Steel	ASTM A307 Grade B*
14	Gland bolt	Steel	ASTM A307 Grade B*
15	Yoke bonnet bolt	Steel	ASTM A307 Grade B*
16	Bonnet bolt nut	Steel	ASTM A563 Grade A*
17	Gland bolt nut	Steel	ASTM A563 Grade A*
18	Yoke bonnet bolt nut	Steel	ASTM A563 Grade A*
19	Gland packing	Non-asbestos	
20	Gasket	Non-asbestos	
21	Sleeve nut	Cast iron	ASTM A126 Class B
22	Knock pin	Steel	ASTM A36
23	Nameplate	Aluminum plate	ASTM B209-1100

*Zinc plated

Dimensions & Weights (inches-lbs.)

Size	1-1/2	2	2-1/2	3	4	5	6	8	10	12	14
L	-	7.00	7.50	8.00	9.00	10.00	10.50	11.50	13.00	14.00	15.00
H	-	13.90	16.2	18.60	21.70	25.80	29.80	37.70	46.10	53.70	59.90
D1	-	7.10	7.10	7.10	7.90	9.10	9.80	11.00	14.20	15.70	19.70
D	-	6.00	7.00	7.50	9.00	10.00	11.00	13.50	16.00	19.00	21.00
C	-	4.75	5.50	6.00	7.50	8.50	9.50	11.75	14.25	17.00	18.75
T	-	0.62	0.69	0.75	0.94	0.94	1.00	1.12	1.19	1.25	1.38
N	-	4	4	4	8	8	8	8	12	12	12
h	-	0.75	0.75	0.75	0.75	0.88	0.88	0.88	1.00	1.00	-
G	-	0.62	0.62	0.62	0.62	0.75	0.75	0.75	0.88	0.88	-
Wt.	-	31	44	53	80	105	138	225	371	513	828

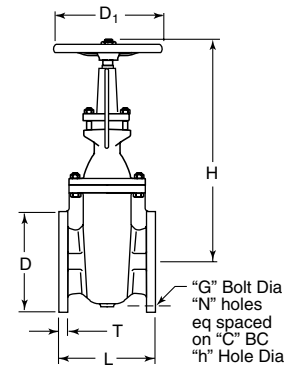
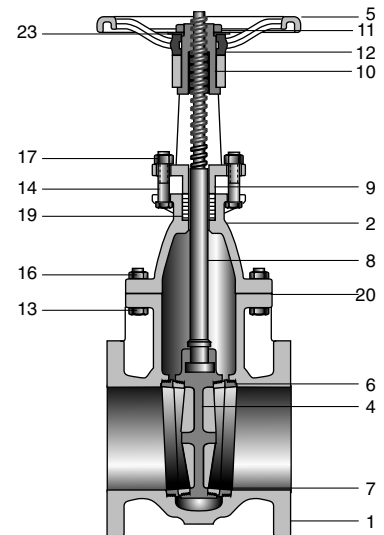

Notes:

1. Face to face dimensions for flanged gate valves conform to ANSI B16.10.
2. End flange dimensions and drilling conform to ASME B16.1. End flanges are fully flat faced and smooth finished on the joint side in accordance with MSS-SP-6.
3. Pressure-temperature ratings conform to those specified in MSS-SP-70.
4. Disc seat rings in all sizes are pressed into discs.
5. Bodies are reinforced with a lateral rib in sizes 10" and larger.
6. For sizes 4" and larger, by-pass bosses are provided at A, B, E & F positions in accordance with MSS-SP-45.
7. For sizes 10", 12", & 14", yoke is separated from bonnet as Fig. 1.

Imfluid RED- WHITE
VALVE CORP.