



HS VALVE

FLOATING
BALL VALVES



 **HS VALVE CO., LTD.**

GREETING

HS Valve co., Ltd. was funded in 1987 with a mandate to become a world class manufacturer of Ball, gate, globe & check Valve to meet the high standards of the Oil and Gas, Chemical and Refined Petroleum markets.

HS Valve is committed to excellence and our in house quality controls are in accordance with ISO 9001, We thoroughly inspect and test every valve to ensure only 100% quality products leave our factory.

We have our valves working throughout the World from the Middle East to Canada and USA.

We look forward to working with you and the opportunity to earn your valued business.

Sincerely,

Won Gyu Chang
President



COMPANY PROFILE

- 1987. 03 Established HS VALVE CO., LTD.
- 1987. 04 HS VALVE CO.LTD. incorporated.
- 1996. 12 Received Mayor's Award
- 1997. 11 Received President's Award
- 1999. 03 **Acquired ISO9001, API-6D**
- 1999. 09 Venture Enterprise
- 1999. 10 Received President's Award
- 1999. 11 Received Mayor's Award
- 2000. 03 Designated excellent technical competition enterprise
- 2000. 03 **Listed in KOSDAQ**
- 2000. 10 Started to manufacture Gas Filter
- 2001. 03 Acquired Fire tests for Ball valve - API 607
- 2001. 10 Superiority Technology Enterprise Selection Technique
-KOREA TECHNOLOGY CREDIT GUARANTEE FUND-
- 2001. 11 Received President's Award
- 2003. 03 Awarded a model taxpayer
- 2003. 06 Received A Men of Merit's Award
- 2004. 01 **Acquired CE(CE0036-Tuv Suddeuschland)**
- 2004. 07 Selected of World Leading SME appointed by Gyeongsangbuk-do
- 2004. 12 **Acquired Fire tests(Ball valve)-API 6FA**
- 2006. 05 **Acquired ISO 9001:2000(0588)-API**
- 2006. 05 **Acquired ISO/TS 29001(TS-0125)-API**
- 2006. 05 **Acquired API Spec Q1(Q1-0319)-API**
- 2006. 11 Awarded the Order of Industrial Service Merit of Silver Tower
- 2007. 12 The head office building Purchase/Move
- 2008. 09 **Acquired GOST R & HYGIENIC**
- 2009. 06 **Acquired GOST RTN**

CERTIFICATES

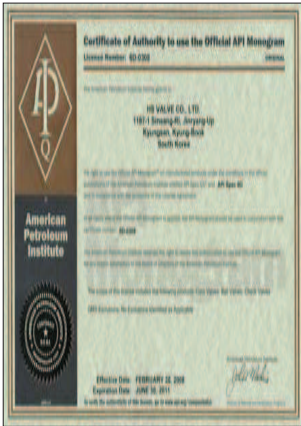

API 6D Certificate



ISO 9001 Approval Certificate



CE0036 Certificate



GOST R Certificate



API Q1 Certificate



ISO/TS 29001 Approval Certificate



API 607 Fire Safe Certificate



GOST RTN Certificate

QUALITY

HS Valve are guaranteed by ISO 9001 and API Q1 audited quality standards.

HS Valve provides the highest quality valves to meet customer's requirements and are manufactured in accordance with API, ASME and other standards.

HS valve are tested and documented to the API 6D and API 598.

HS valve are manufacture to comply with NACE standard and provide complete material's tractability.

CONSTRUCTION & FUNCTION

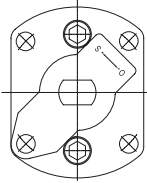

Locking Device

HS VALVE are lockable in either full open or closed position.

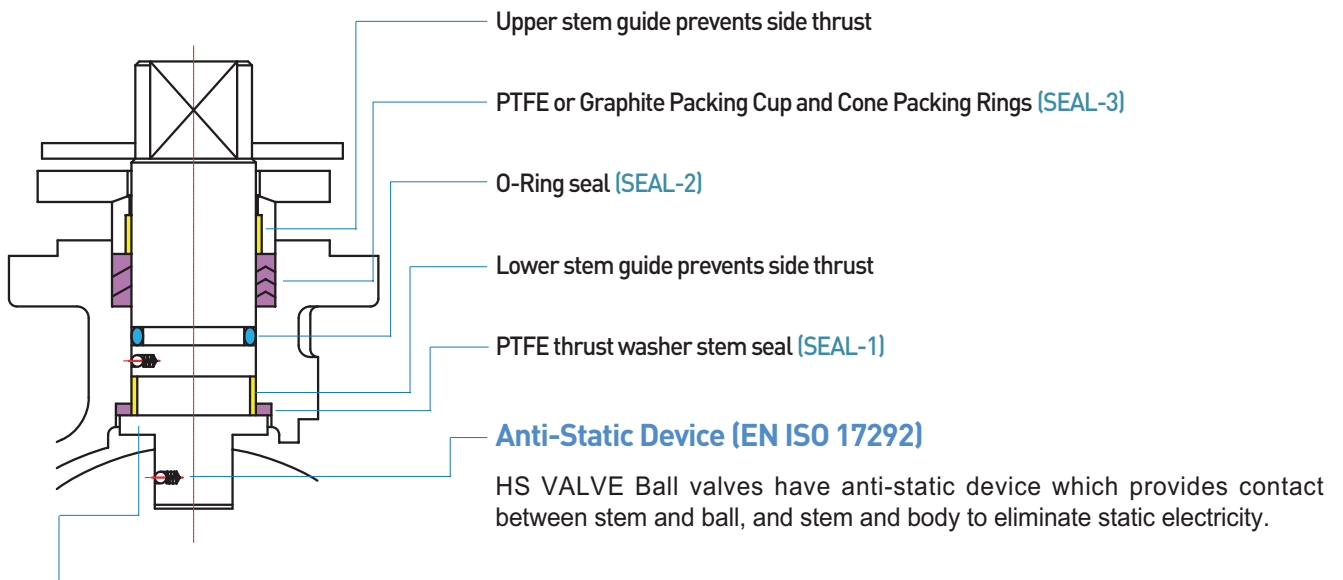

Blow-Out Proof Stem

All HS VALVE Ball valves have an anti blow out proof stem designed to back seat during any excess line pressure situation that is not higher than the design pressure of the valve and will help prevent product loss during a fire.

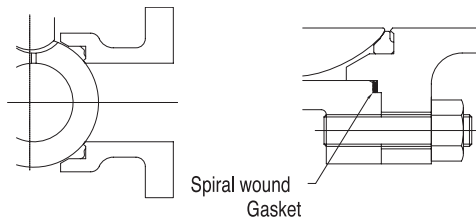

Fire Safe Design (API 607 / API 6FA)

In the event of a fire, the valve is required to make a downstream seal. Even after the disintegration of the TEFLON seats, HS BALL Valves provide an excellent metal to metal seal. Special attention has been paid to the mechanical strength and sealing efficiency of the central flanged joint of the valve body & cap. Heavy casting & graphite filled spiral wound gasket assures zero Body / joint leakage.

CLASS 150 & 300 FLOATING BALL VALVES

FIG. NO. BFFA15, A30 / BFRA15, A30

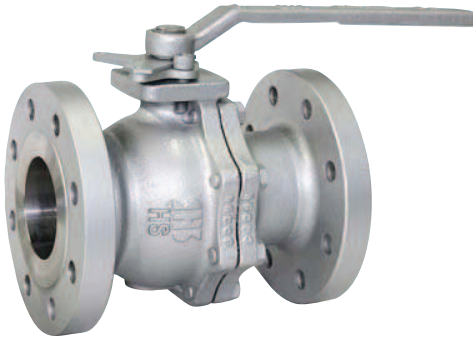

Construction

- 2-Piece body, Full & Reduced Bore.
- Floating Ball.
- Fire Safe Design.
- Anti-static Device.
- Locking Device.
- Blow-out Proof stem.
- ISO 5211 Mounting Pad.
- Cavity Relieving seats.

Basic Materials

Part Name	Carbon Steel	Stainless Steel
Body	A216-WCB, A352-LCC	A351-CF8, CF8M
Ball	A351-CF8, CF8M	
Seat	RPTFE	

Production Specifications

Basic Design	API 6D & ASME B16.34
Face to Face	ASME B16.10
End Flange	ASME B16.5
Test & Inspection	API 6D & API 598

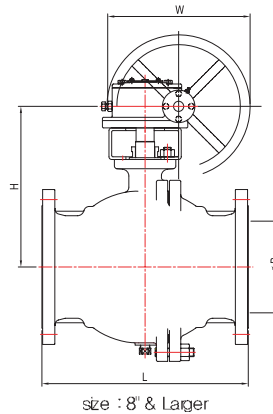
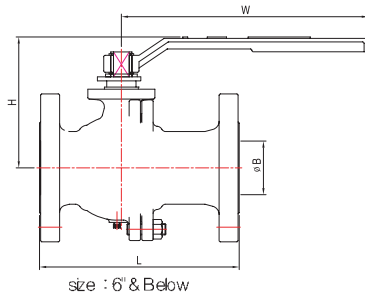

Range & Dimensions

(unit : mm)

Valve Size	1/2"	3/4"	1"	1 1/4"	1 1/2"	2"	3 x 2"	3"	4 x 3"	4"	6 x 4"	6"	8 x 6"	8"	10 x 8"
B	13	19	25	32	38	51	51.0	76	76	102	102	152	152	203	203
L	150#	108	117	127	140	165	178	203	203	229	229	349	394	457	533
	300#	140	152	165	178	191	216	282	282	305	305	403	403	502	568
H	82	85	100	115	125	138	138	174	174	200	200	275	275	327	327
W	130	160	160	160	240	240	240	240	240	350	350	440	440	400	400
Weight (kg)	150#	2.5	3.0	4.6	6.5	8.0	9.0	13.3	22.0	25.0	34.0	49.0	84.0	102.0	178.0
	300#	3.0	3.5	5.5	7.5	9.0	13.7	22.0	31.0	39.0	46.0	69.0	133.0	175.0	206.0

• Other Material & Size is Available upon Request.